

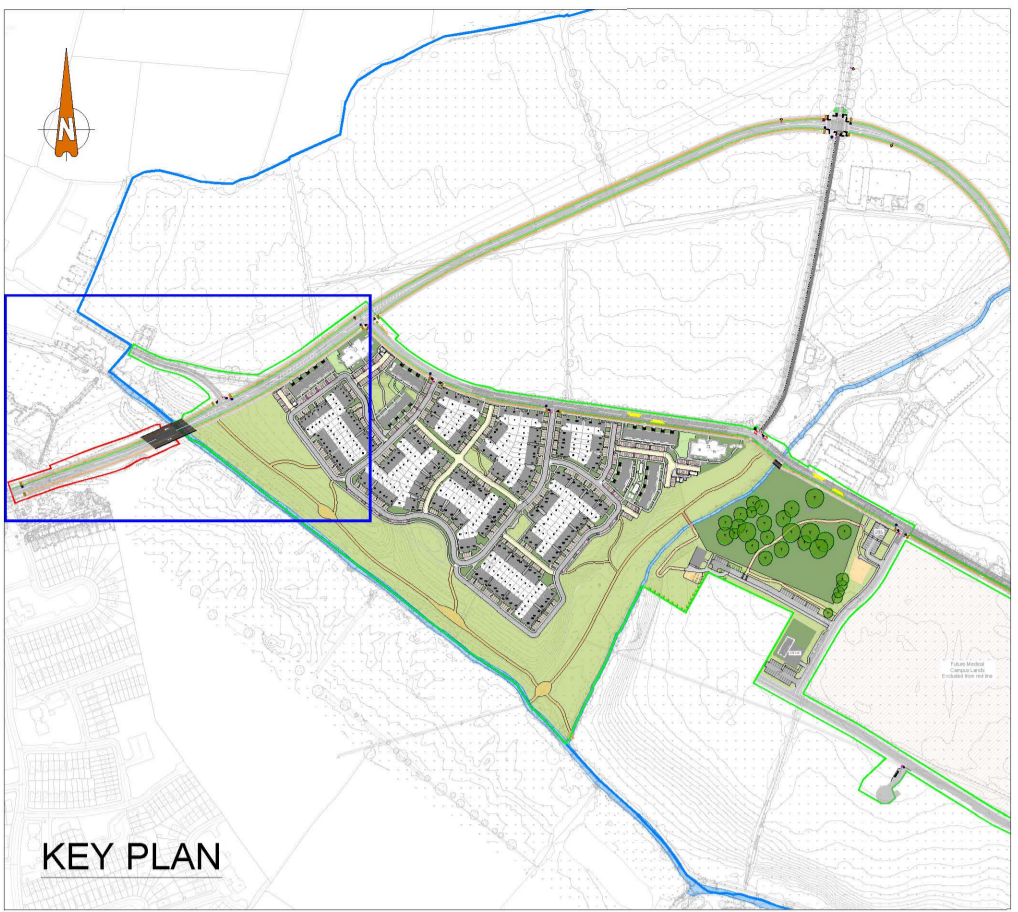

## **APPENDIX 4-1**

**SITE LAYOUT PLANNING  
DRAWINGS**



**ROAD MARKINGS LEGEND**

	- 100mm CENTRE LINE (RRM 002B)
	- 100mm CENTRE LINE (RRM 001)
	- 150mm 'STOP' LINE (RRM 017)
	- LANE INDICATION ARROWS (RRM 006)
	- CYCLE LANE MARKING (M116)
	- CYCLE LANE DIRECTION ARROW (M118)
	- 150mm GIVE WAY MARKING (M115C)
	- 'STOP' SIGN (RUS 027)
	- SPEED LIMIT SIGN (RUS042)
	- SEPARATED TWO WAY FOR PEDESTRIANS AND CYCLISTS ONLY (TSM-RUS 058CR)

**LEGEND**

	PROPOSED CARRIAGEWAY
	PROPOSED SHARED SURFACE
	PROPOSED FOOTPATH
	PROPOSED SHARED SPACE
	PROPOSED LANDSCAPING FOOTWAY
	PROPOSED VERGE / LANDSCAPING
	PROPOSED CYCLE PATH
	PROPOSED RAISED TABLE
	PROPOSED CAR PARKING
	PROPOSED ROAD MARKINGS
	PROPOSED TRAFFIC SIGNAL

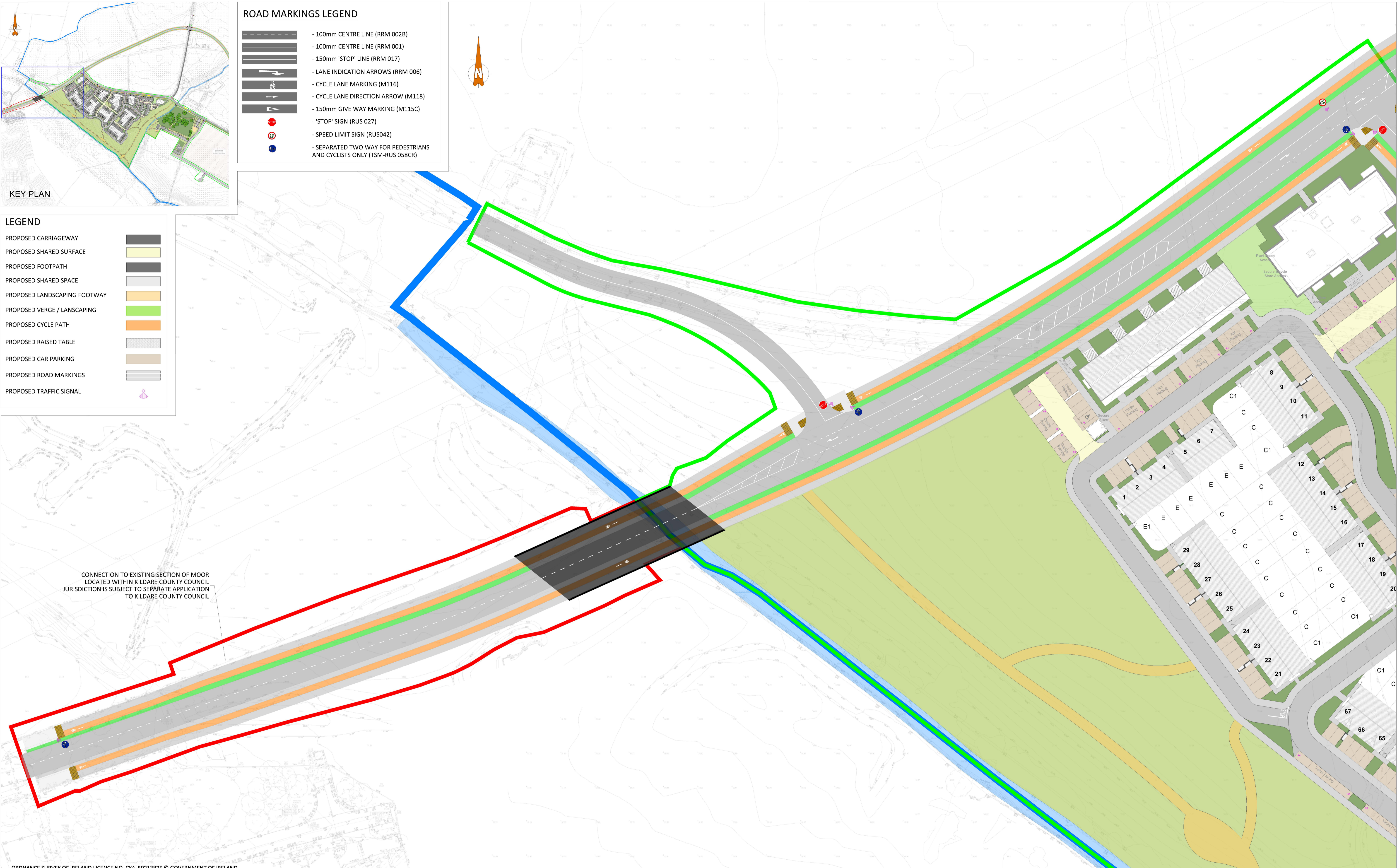

CONNECTION TO EXISTING SECTION OF MOOR LOCATED WITHIN KILDARE COUNTY COUNCIL JURISDICTION IS SUBJECT TO SEPARATE APPLICATION TO KILDARE COUNTY COUNCIL

ORDNANCE SURVEY OF IRELAND LICENCE NO. CYAL50213875 © GOVERNMENT OF IRELAND

- FOR SETTING OUT REFER TO ARCHITECT'S DRAWINGS.
- THIS DRAWING TO BE READ IN CONJUNCTION WITH ALL OTHER ARCHITECTURAL AND ENGINEERING DRAWINGS AND ALL OTHER RELEVANT DRAWINGS AND SPECIFICATIONS.
- DO NOT SCALE THIS DRAWING. USE FIGURED DIMENSIONS ONLY.
- NO PART OF THIS DOCUMENT MAY BE REPRODUCED OR TRANSMITTED IN ANY FORM OR STORED IN ANY RETRIEVAL SYSTEM OF ANY NATURE WITHOUT THE WRITTEN PERMISSION OF O'CONNOR SUTTON CRONIN AS COPYRIGHT HOLDER EXCEPT AS AGREED FOR USE ON THE PROJECT FOR WHICH THE DOCUMENT WAS ORIGINALLY ISSUED.

Rev No.	Date	Revision Note	Drn by	Chkd by
P01	15/10/21	SUITABLE FOR INFORMATION	RM	MK
P02	01/12/21	SUITABLE FOR INFORMATION	RM	SMG
P03	07/12/21	SUITABLE FOR STAGE APPROVAL	RM	SMG
P04	11/08/22	FOR PLANNING	RM	WM

Rev No.	Date	Revision Note	Drn by	Chkd by

**PLANNING DRAWING.**  
 NOT FOR CONSTRUCTION.  
 ALL LEVELS GIVEN ARE  
 RELATIVE TO ORDNANCE DATUM.  
 THIS DRAWING HAS BEEN ISSUED FOR INFORMATION  
 PURPOSES ONLY AND MUST NOT BE USED  
 FOR CONSTRUCTION UNDER ANY CIRCUMSTANCES

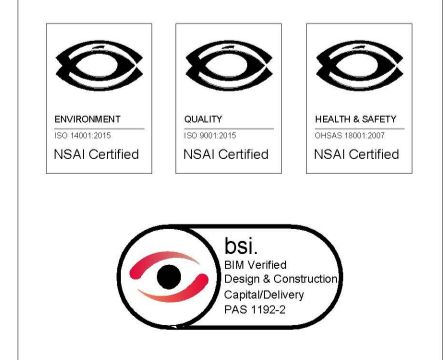

Head Office,  
 9 Prussia Street,  
 Dublin 7,  
 D07 KT57

TEL +353 (0)1 8682000

e: [contactus@ocsc.ie](mailto:contactus@ocsc.ie)  
 w: [www.ocsc.ie](http://www.ocsc.ie)

Dublin | London | Belfast | Galway | Cork | Birmingham



Client:	SKY CASTLE LTD									
Project:	MOYGLARE BRIDGE									
Title:	ROADS GENERAL ARRANGEMENT									
Code	Originator	Zone	Level	Type	Role	Number	Status	Revision		
S665	OCSC	1C	KE	DR	C	0111	S4	P04		
Date:	OCT '21	Scale:	1:500	@ A1	Drn by:	RM	Chkd by:	MK	Aprvd by:	MK